



**AMERICAN TOWER®**  
 A.T. ENGINEERING SERVICE, PLLC  
 3500 REGENCY PARKWAY  
 SUITE 100  
 CARY, NC 27518  
 PHONE: (919) 466-0112

THESE DRAWINGS AND/OR THE ACCOMPANYING SPECIFICATION AS INSTRUMENTS OF SERVICE, ARE THE EXCLUSIVE PROPERTY OF LESSOR/SITE OWNER AND THEIR USE AND PUBLICATION SHALL BE RESTRICTED TO THE ORIGINAL SITE FOR WHICH THEY ARE PREPARED. REUSE, REPRODUCTION OR PUBLICATION BY ANY METHOD, IN WHOLE OR IN PART, IS PROHIBITED EXCEPT BY WRITTEN PERMISSION FROM LESSOR/SITE OWNER. TITLE TO THESE PLANS AND/OR SPECIFICATIONS SHALL REMAIN WITH LESSOR/SITE OWNER WITHOUT PREJUDICE AND VISUAL CONTACT WITH THEM SHALL CONSTITUTE PRIMA FACIE EVIDENCE OF ACCEPTANCE OF THESE RESTRICTIONS.

ALL MEASUREMENTS AND LOCATIONS USED IN THIS SITE DESIGN ARE APPROXIMATE AND LESSOR/SITE OWNER MAKES NO REPRESENTATIONS OR WARRANTIES AS TO UNDERGROUND FEATURES, INCLUDING BUT NOT LIMITED TO UTILITIES, ROCK FORMATIONS, ETC. THIS SITE DESIGN SHALL NOT BE USED FOR CONSTRUCTION PURPOSES AND LESSEE SHOULD CONTACT AND UTILIZE A UTILITY LOCATOR SERVICE PRIOR TO COMMENCING CONSTRUCTION TO AVOID SERVICE DISRUPTION TO OTHER USERS AND INJURY OR DEATH

ATC SITE NUMBER:  
**206408**  
 ATC SITE NAME:  
**SPEARFISH LAWRENCE SD  
 SOUTH DAKOTA**

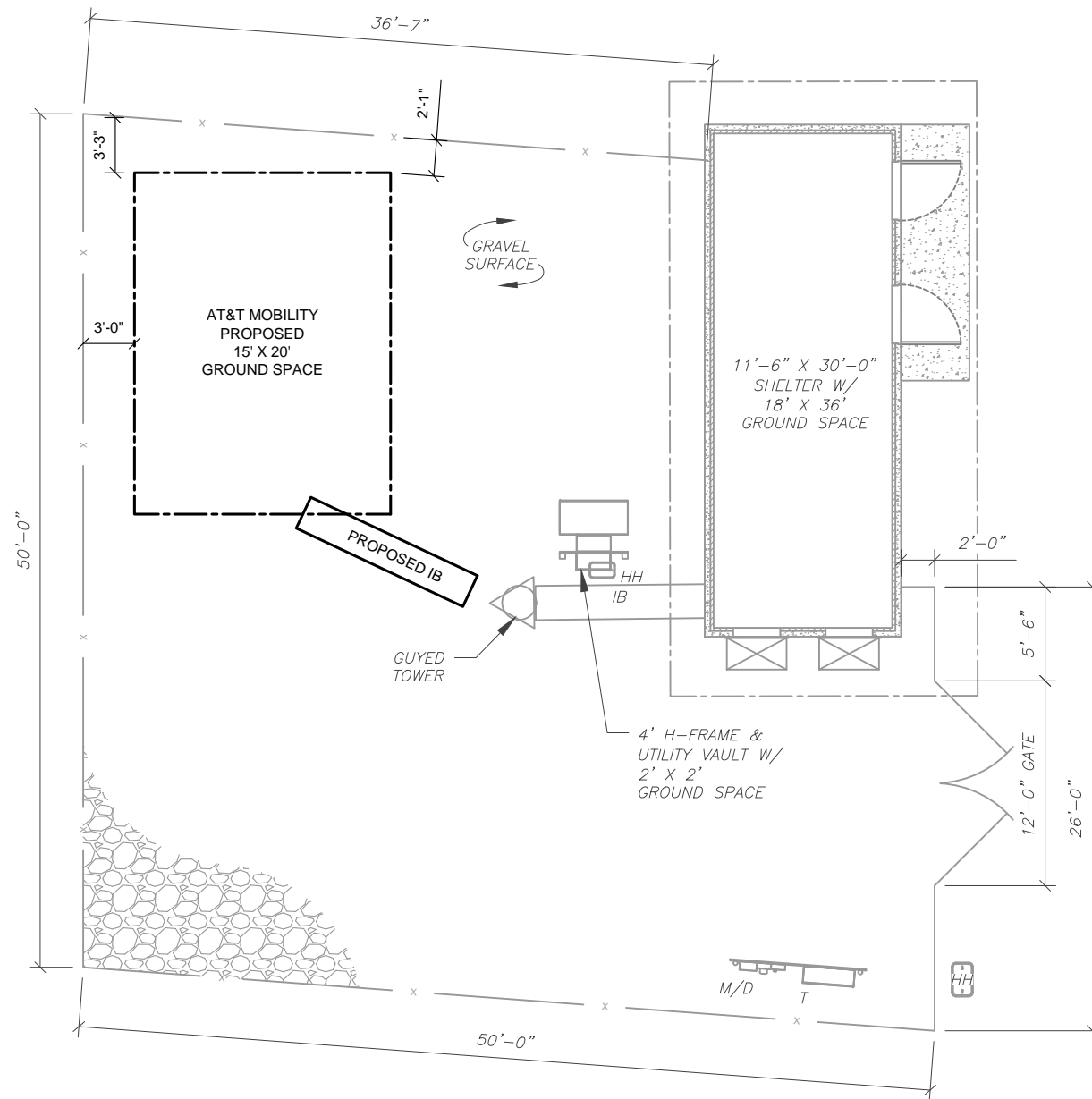

NOTE:  
 ATC LEASE AREA = 600' X 600'

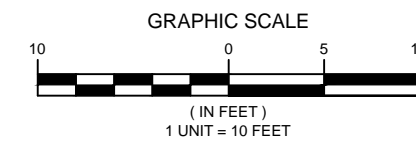

LEGEND	
⊗	GROUNDING TEST WELL
AV	AIR VENT
ATS	AUTOMATIC TRANSFER SWITCH
B	BOLLARD
C	CABINET
CS	COAX SHROUD
CSC	CELL SITE CABINET
D	DISCONNECT
E	ELECTRICAL
F	FIBER
GEN	GENERATOR
G	GENERATOR RECEPTACLE
HH, V	HAND HOLE, VAULT
HFC	HYDROGEN FUEL CELL
HSM	HYDROGEN STORAGE MATERIAL
IB	ICE BRIDGE
K	KENTROX BOX
LC	LIGHTING CONTROL
LPG	LIQUID PROPANE GAS
M	METER
MTS	MANUAL TRANSFER SWITCH
OHW	OVERHEAD WIRE
P	POWER
PP	POWER POLE
T	TELCO
TRN	TRANSFORMER
---	BUFFER (PROPERTY LINE)
----	GROUND SPACE (LEASE AREA)
-----	EASEMENT

DRAWN BY:	K.FLANAGAN
DATE DRAWN:	08/03/21
CUSTOMER:	AT&T MOBILITY
ATC PROJECT NO.:	OAA768136
ATC ASSET NO.:	206408

**SITE PLAN LAYOUT**

SHEET NUMBER:	AUDITED BY
<b>SITE-1</b>	KPF ON 05/27/20