

**LAWRENCE COUNTY APPLICATION FOR UTILITY PERMIT**  
**PERMIT NO. \_\_\_\_\_**

Highway No. <sup>CR 205/Rochford Rd.</sup> \_\_\_\_\_ County Lawrence Approximately 60 ft Miles

From Crossing vicinity Hanna Rd for construction of Buried Fiber Optic cable  
(City or well defined point) (Type of utility facility)

Begin Section 31 Township 4N Range 3E End Section 31 Township 4N Range 3E

Intended usage or rating placement of fiber optic cable

Cable size and Type 3/4" ; 144 fiber

Outside pipe diameter 1.25"

Maximum pipeline operating pressure n/a

Size and type of metal casing n/a

Minimum depth of cable or pipeline 48"

Method of Installation Direct Bore

Approximate construction dates: START 3/31/19 FINISH 9/30/19

Special Conditions \_\_\_\_\_

I, the undersigned, request permission to construct and maintain a utility facility on public right-of-way at the above location and as shown on the attached layout sheet and in accordance with provisions of Administrative Rule Chapter 70:01:08 of the South Dakota Department of Transportation. In consideration for this permission, I agree to abide by all conditions as herein stated.

1. To furnish all materials, labor, incidentals and pay all costs involved with the construction and maintenance of the utility facility. To perform approved open cut trench operations in accordance with current Open Cut Trench Policy. To restore any damaged portions of the roadway and right-of-way to equal or better conditions than existed prior to beginning work covered by this permit
2. To provide protection to highway traffic during construction and maintenance by the use of proper signs, barricades, flag persons and lights as prescribed in the "Manual of Uniform Traffic Control Devices".
3. To furnish a performance bond if deemed necessary by the Lawrence County Commissioners.
4. In the event it is deemed necessary by the Lawrence County Commissioners to move or alter the line in any way due to maintenance or highway construction within its present right-of-way width, the alteration will be accomplished by the owner without cost to Lawrence County.

NO WORK SHALL COMMENCE UNTIL A SIGNED PERMIT IS IN HAND AND ON SITE WITH CONTRACTOR

# PERMIT DRAWING

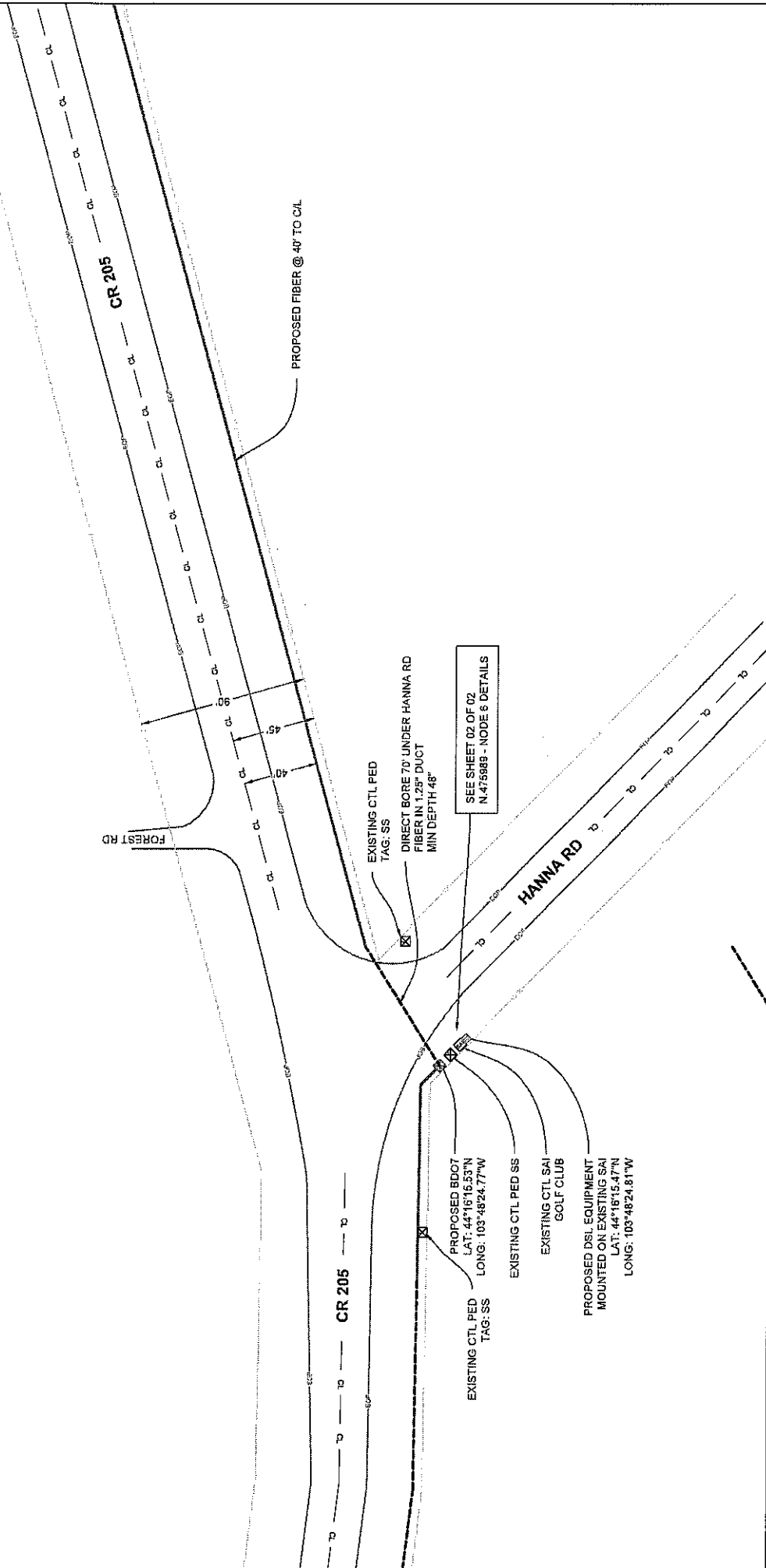

<p>SCALE: 1" = 50'</p>	<p><b>CROSSING DETAIL</b></p>
<p><b>LEGEND</b></p> <ul style="list-style-type: none"> <li><input checked="" type="checkbox"/> PROPOSED REESTABL</li> <li><input checked="" type="checkbox"/> EXISTING REESTABL</li> <li><input checked="" type="checkbox"/> EXISTING MARE</li> <li><input checked="" type="checkbox"/> EXISTING POWER FILE</li> <li><input type="checkbox"/> EXISTING SAI</li> <li><input type="checkbox"/> EXISTING ELECTRIC</li> <li><input type="checkbox"/> EXISTING COLEED</li> <li><input type="checkbox"/> EXISTING POWER FILE</li> </ul>	<p>FACE OF ADJACENT EDGE OF DIRT ROAD RIGHT OF WAY CENTERLINE PROPOSED BORE PROPOSED FIBER</p>
<p>JOB: N.458725 LOC.: CR 205 LEAD: SD 57754</p>	<p>CONTACT PERSON: KIRK RAUSCH OFFICE: 605-594-4720 CELL: 605-519-1146 EMAIL: KIRK.RAUSCH@CENTURYLINK.COM</p>
<p>PERMITS REQUIRED: LAWRENCE COUNTY W/C: LEADSDCO CPA: TSMITH</p>	<p><b>CenturyLink</b> 612 MT RUSHMORE RD RAPID CITY, SD 57701</p>